

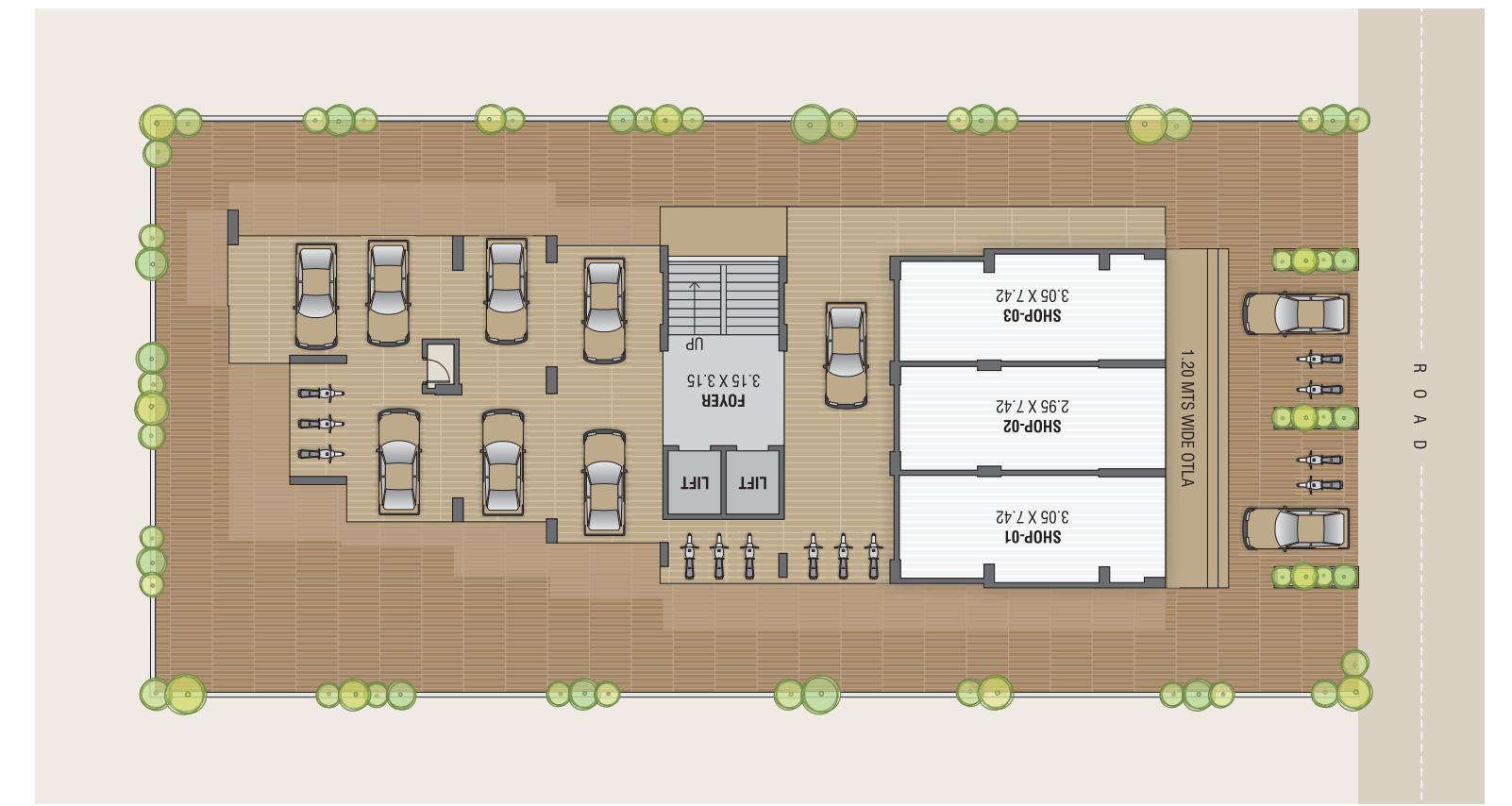

TYPICAL 1 FLOOR PLAN

1	3 BHK	1241 SQ. FT.
2	3 BHK	1215 SQ. FT.
3	2 BHK	1013 SQ. FT.
4	2 BHK	1067 SQ. FT.



Specifications

Flooring
24"x24" vitrified tiles in entire apartment.

Kitchen
Granite platform with S.S. sink & above platform provide glazed tile dedo up to lintel level.

Plumbing
Concealed plumbing with standard UPVC/CPVC pipe fitting. Premium quality CP fittings.

Toilet
Good quality Glazed tiles in floor & dado up to lintel level.

Walls
All internal wall will be finished with Single mala plaster with wall putty, external wall will be finished with water proof Acrylic paint.

Doors & Windows
Decorative main entrance door in Wooden frame and all other doors are flush door in Wooden frame. All windows are in powder coated Alluminium section sliding windows.

Electrification
Concealed Copper wiring with ISI mark & Modular switches for adequate number of points in all rooms.

Developers



FORTUNE DREAM CON PVT. LTD.
Mo : 97235 58881
Mo : 97235 50160
sales.fortunedreamcon@gmail.com
www.fortunedreamcon.com

Site Address
FORTUNE TEMPLE,
Sr. No. 48/243 & 48/244,
Nr. Jain Temple, Nani Daman,
Daman - 396 210 (U.T.)

NOTES ■ All rights are reserved to Developer for any changes in plan & specification. ■ Irregular payment shall cause cancellation of booking. ■ DEB, Stamp duty, Legal charges, Service Tax, Other Tax & Initial maintenance contribution will be levied extra. ■ Any additional liabilities due to change in the by laws, Stamp duty, Govt. Laws, shall be borne by member. ■ Change in external elevation shall not be permitted. Internal changes shall be done only with prior permission & shall be charged extra in advance. ■ Details & dimensions in brochure are indicative & for the tentative representation only which should not be treated as legal documents. ■ Possession of the unit shall be given only after full payment.



FORTUNE DREAM-CON | **FORTUNE TEMPLE**

2 & 3, BHK EXCLUSIVE APARTMENTS & SHOPS AT DAMAN

DESIGN LAB Mo : 9376 113144